

# We Plan—You Plant!

Name: \_\_\_\_\_ Home phone: \_\_\_\_\_

**Thank you for taking the first step toward a more beautiful garden!** If you haven't scheduled your 45-minute design consultation yet, call us at 636.7662. Consultations are available on Tuesdays, Wednesdays, and Saturdays at 10 am, 12 pm, 2 pm, or 4 pm. The fee is the purchase of a \$50 Rockledge Gardens gift certificate towards plant purchases. Once your consultation is confirmed, you can note it here:

Consultation date: \_\_\_\_\_ Time: \_\_\_\_\_

Before your appointment, please use this worksheet to gather some preliminary information so that we can use your scheduled consultation time more effectively. Please bring in this worksheet for your consultation; also bring in several photos showing the area from different angles.

Describe the area you would like to enhance or design (such as front, backyard, pool area, etc.).

\_\_\_\_\_

What you would like to accomplish (such as enhancing, screening, shading, outdoor room, etc.)?

\_\_\_\_\_

How many hours of sun does the area receive during the day? \_\_\_\_\_

Any color preferences you'd like to incorporate in the design? \_\_\_\_\_

Does the area have good drainage? Is it usually wet or dry? \_\_\_\_\_

Do you have an irrigation system? \_\_\_\_\_

What is the water source (city, well, reclaimed, pond)? \_\_\_\_\_

If well water, what is the salt content? \_\_\_\_\_ ppm  
(If you don't know, bring in a sample and we'll test it for free. We'll tell you how to take the sample.)

Please use the following pages for including other helpful information to help us design your garden.

# Rockledge Gardens

2153 Hwy #1 • Rockledge • 321.636.7662  
[www.rockledgegardens.com](http://www.rockledgegardens.com)



# Measuring your garden area

Before you come in for your consultation, please take some measurements of your site. You can use the graph sheet we've provided, and the sample planning sketch below shows one way of indicating the size of the area and its features.

Please bring photos as well, showing the site from several different angles, and any important features.

Be sure to include notes about features that should be taken into account in the design, such as windows and doors; gas, electric, phone, or cable TV lines; air conditioning units and downspouts; and driveways and walkways.

Also please note any existing plants in the project area that you would like to keep in the design. Don't forget to indicate the North/South orientation on your sketch.

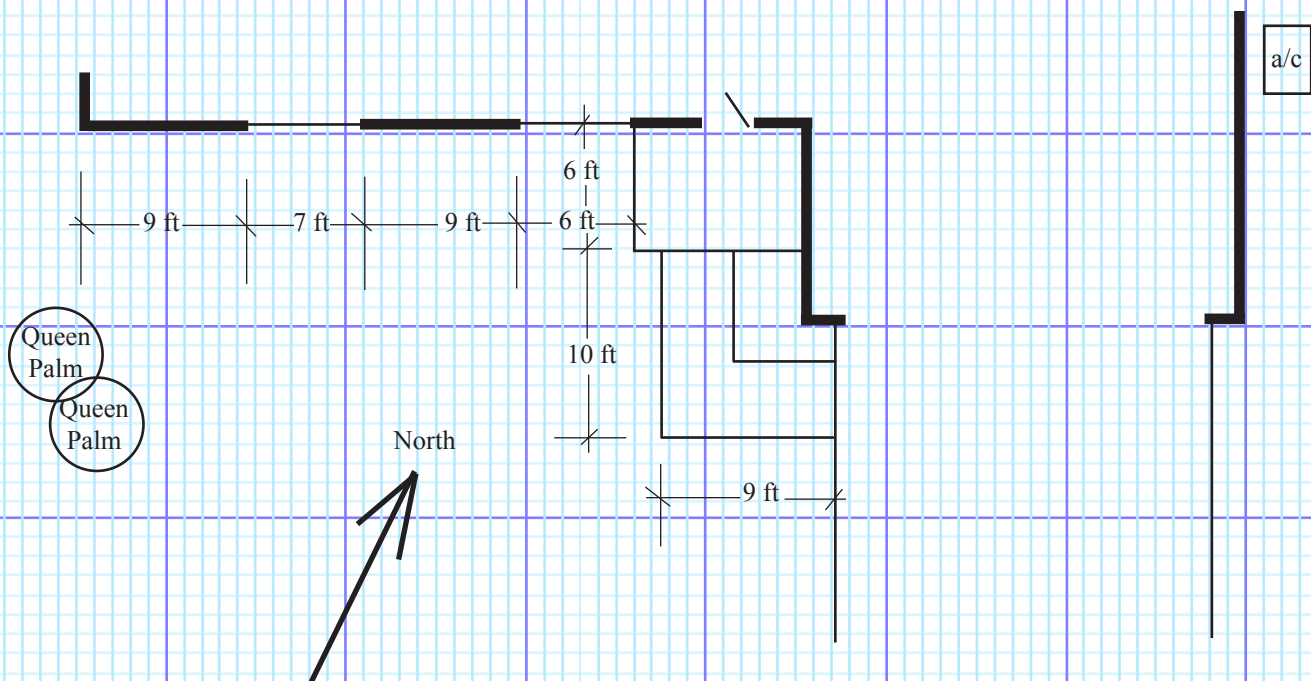

Name: \_\_\_\_\_

# Your site measurements

Scale: one small square = 1 ft  
One large square = 10 ft

